

watersino[®]

Installation instruction

The instruction of single lever cold and hot basin mixer

Product introduction

(I). Notification :

- 1.Please check the mixer and all the accessories once you opened the package .
- 2.The printed picture is for reference only , the product is according to the real goods .
- 3.We reserve the right to change the accessories without prior notice if the replacement is not influencing the use .
- 4.Thank you for selecting us and buying our products.

(II).Please check accessories : (refer to the picture on the right)

03	Flexible pipe	2	S.S	Red and blue
02	Sleeve group	1	S.S	With gasket
01	Main body of the mixer	1	brass	With gasket
Number	Name	Quantity	Material	Note

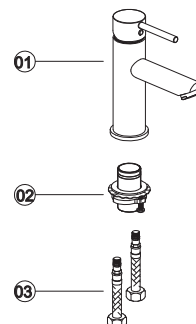

Installation instructions

(I). Important note

1. Under the dynamic pressure: $0.1 \pm 0.01\text{Mpa}$ water pressure, the water nozzle (with accessories) for basin, washing and kitchen , the rate of flow is $\leq 0.15\text{L/S}$.
- 1.2 Under the dynamic water pressure of $0.3+0.02\text{Mpa}$, the shower mixer is $\geq 0.33\text{L/S}$.The Basin, shattaf , sink and the spray head is $\geq 0.20\text{L/S}$.
2. Temperature recommendation: $4^{\circ}-80^{\circ}$,Working Pressure:150kpa to 500kpa.

(II). Precautions:

1. Necessity in cleaning the dirt in the embedded water pipe before installation.
2. Necessity inspection for tight connection in every parts and water leakage after installation.
3. To avoid cracking , please make sure the water inlet flexible pipes are not twisted when in use.

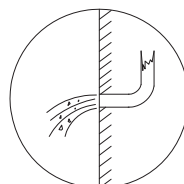

Sluice the pipe

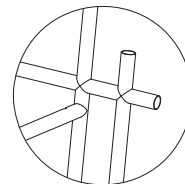

check the pipe

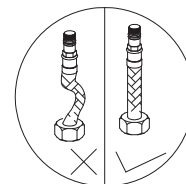

Hose installation

(III).Installation procedures:

1. Get all the accessories ready according to the picture , the left hose (in red) is for hot water inlet , and the right hose (in blue) is for cold water inlet . Please install one hose first .
2. Please install the mixer to basin by using the sleeve , install the second hose to the mixer body too .
3. Please connect two water inlet hoses to the angle valve by the hot and cold water indicates on the mixer handle.
4. After fixing the mixer, open the mixer and check if there is any leaking.

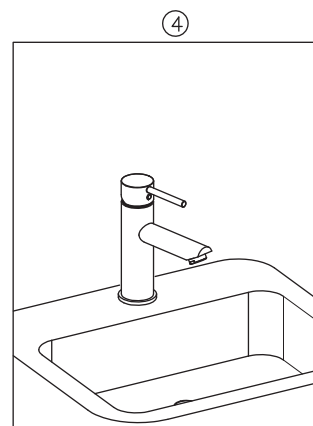
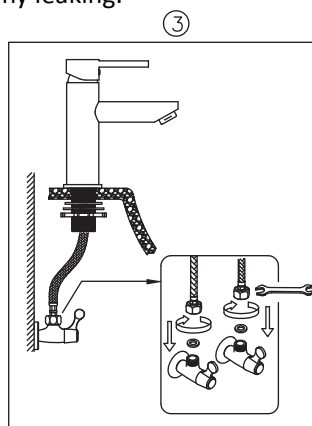
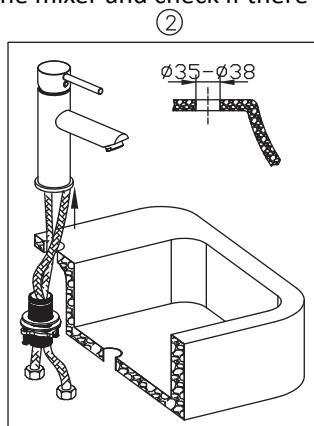
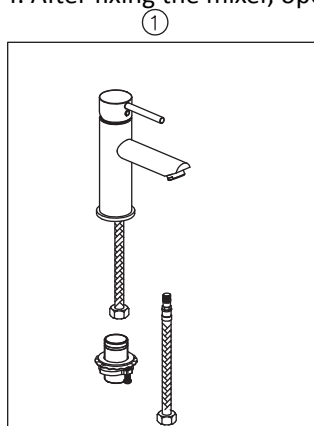

Maintenance:

Clean the surface frequently or in a regular basis to keep it bright.

- 1.To mop the mixer's surface frequently by using clean water, colorless glass cleaner and soft fabric , not the abrasive liquid or material .
- 2.DO NOT use acid cleaner to clean the mixer , the electroplating surface is corrosive.
- 3.DO NOT use any coarse cleaner powder or brush to clean the mixer.
- 4.Under regular water pressure, when the flow is reducing , please brush the parts after vinegar soaking .

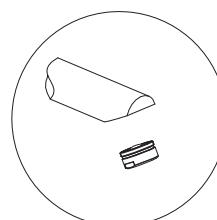
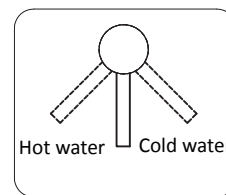
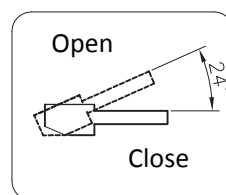

Working illusion of the spout

The instruction of single lever cold and hot kitchen mixer

Product introduction

(I). Notification :

- 1.Please check the mixer and all the accessories once you opened the package .
- 2.The printed picture is for reference only , the product is according to the real goods .
- 3.We reserve the right to change the accessories without prior notice if the replacement is not influencing the use .
- 4.Thank you for selecting us and buying our products.

(II).Please check accessories : (refer to the picture on the right)

02	Flexible pipe	2	S.S	Red and blue
01	Main body of the mixer	1	brass	With gasket
Number	Name	Quantity	Material	Note

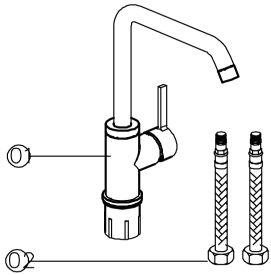

Installation instructions

(I). Important note

- 1. 1 Under the dynamic pressure: 0.1 ± 0.01 Mpa water pressure, the water nozzle (with accessories) for basin, washing and kitchen , the rate of flow is ≤ 0.15 L/S.
- 1.2 Under the dynamic water pressure of $0.3 + 0.02$ Mpa , the shower mixer is ≥ 0.33 L/S .The Basin, shattaf , sink and the spray head is ≥ 0.20 L/S .
- 2. Temperature recommendation: $4^{\circ} - 80^{\circ}$,Working Pressure:150kpa to 500kpa.

(II). Precautions:

- 1. Necessity in cleaning the dirt in the embedded water pipe before installation.
- 2. Necessity inspection for tight connection in every parts and water leakage after installation.
- 3. To avoid cracking , please make sure the water inlet flexible pipes are not twisted when in use.

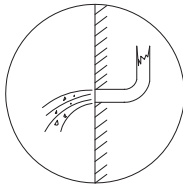

Sluice the pipe

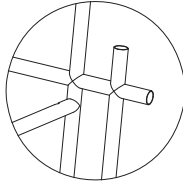

check the pipe

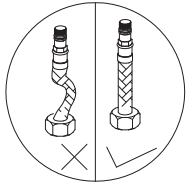

Hose installation

(III).Installation procedures

- 1. Please remove the fixed screw in the sleeve.(Save the accessories)
- 2. Please install the mixer to the sink , install the hose to the mixer body through the nut and get the nut fixed . The skid-proof gasket has to be fixed too .
- 1. 3.1 Please connect two water inlet hoses to the angle valve by the hot and cold water indicates on the mixer handle.
- 3.2 The valve is optional choice for customer .
- 4. Try to turn the spout to left or right and check if there is any leaking in each connector after installation .

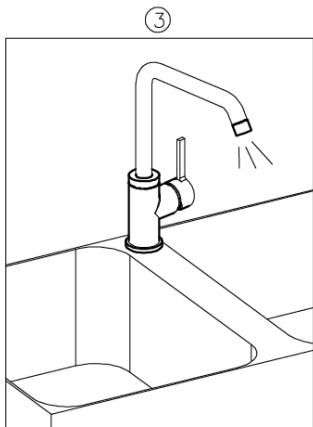
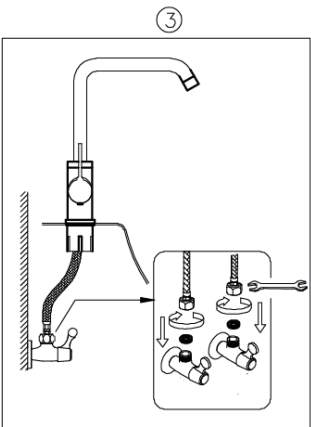
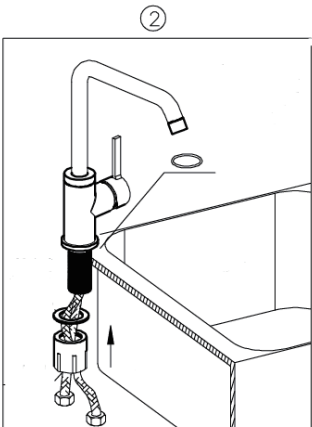
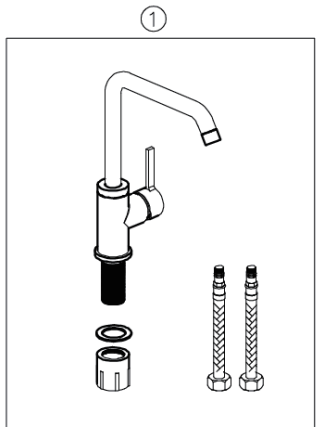

Maintenance:

Clean the surface frequently or in a regular basis to keep it bright.

- 1.To mop the mixer's surface frequently by using clean water, colorless glass cleaner and soft fabric , not the abrasive liquid or material .
- 2.DO NOT use acid cleaner to clean the mixer , the electroplating surface is corrosive.
- 3.DO NOT use any coarse cleaner powder or brush to clean the mixer.
- 4.Under regular water pressure, when the flow is reducing , please brush the parts after vinegar soaking .

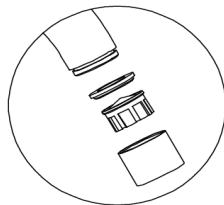
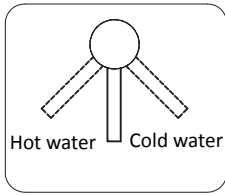
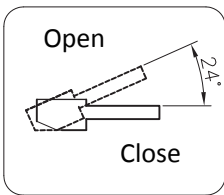

Working illusion of the spout

The instruction of embedded single function shower set

Product introduction

(I). Notification :

- 1.Please check the mixer and all the accessories once you opened the package .
- 2.The printed picture is for reference only , the product is according to the real goods .
- 3.We reserve the right to change the accessories without prior notice if the replacement is not influencing the use .
- 4.Thank you for selecting us and buying our products.

(II).Please check accessories : (refer to the picture on the right)

07	Allen key	1	S.S.	Free accessory
06	shower head	1	Brass	Optional model
05	Shower arm	1	Brass	
04	Decorative ring	1	Brass	
03	Handle	1	Brass	
02	Plate	1	Brass	
01	Concealed main body	1	Brass	
No.	Name	Quantity	Material	Note

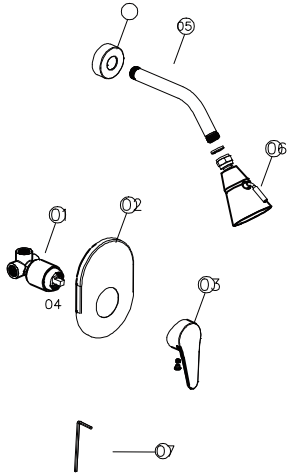

Installation instructions

(I). Important note

- 1. 1 Under the dynamic pressure: 0.1 ± 0.01 Mpa water pressure, the water nozzle (with accessories) for basin, washing and kitchen , the rate of flow is ≤ 0.15 L/S.
- 1.2 Under the dynamic water pressure of $0.3+0.02$ Mpa , the shower mixer is ≥ 0.33 L/S .The Basin, shattaf , sink and the spray head is ≥ 0.20 L/S .
- 2. Temperature recommendation: $4^{\circ}-80^{\circ}$,Working Pressure:150kpa to 500kpa.

(II). Precautions:

- 1.The main body and cartridge of the mixer has already been inspected and tested, please do not disassemble or assemble by yourself.
- 2. Necessity in cleaning the dirt in the embedded water pipe before installation.
- 3.Necessity inspection for tight connection in every parts and water leakage after installation.
- 4. The left side of the pipe is for hot water, the right one is for hot water , make sure they are not on the opposite way .

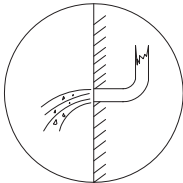

Sluice the pipe

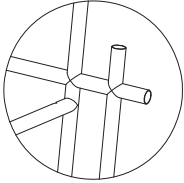

check the pipe

Installation procedures

- 1.Please make a slot inside the wall and bury the tube. Connect the inlet pipes for hot and cold water. Hot water inlet is on the left in red , and the cold water is on the right in blue .
- 2.1 Conceal the pipe in wall as follows. Please try the water before conceal the wall, in case the body and connecting pipes to be cracked.
- 2.2 Please fix the water outlet. Choose an appropriate height to fix the holder for hand held shower head .
- 3.Install the outer part including the diverter, handle, and shower head according to the photo .

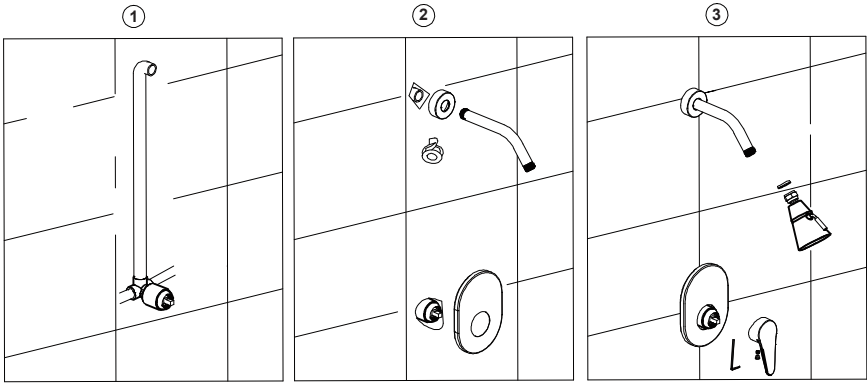

Test

- 1. Turn off the mixer, and turn on the water valve to see if there is any leaking in connectors.
- 2. Turn on the mixer, and turn on the water valve and check water leaking by changing the diverter .
- 3. During using , please don't tweak the hand shower hose wildly in case get cracking.

Maintenance:

- (I) Clean the surface frequently or in a regular basis to keep it bright.

- 1.To mop the mixer's surface frequently by using clean water, colorless glass cleaner and soft fabric , not the abrasive liquid or material .
- 2.DO NOT use acid cleaner to clean the mixer , the electroplating surface is corrosive.
- 3.DO NOT use any coarse cleaner powder or brush to clean the mixer.

(II) Regular cleaning

- 1.Under regular water pressure, when the flow is reducing , please brush the parts after vinegar soaking .

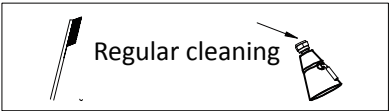
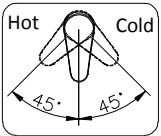
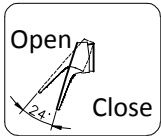

The instruction of embedded two function shower set

Product introduction

(I). Notification :

- 1.Please check the mixer and all the accessories once you opened the package .
- 2.The printed picture is for reference only , the product is according to the real goods .
- 3.We reserve the right to change the accessories without prior notice if the replacement is not influencing the use .
- 4.Thank you for selecting us and buying our products.

(II)Please check accessories : (refer to the picture on the right)

04	Fittings bag	1	S.S.304
03	Handle	1	Zinc alloy
02	Plate	1	S.S.304
01	Embedded main body group	1	brass
No.	Name of the fittings	Quantity	Material Note

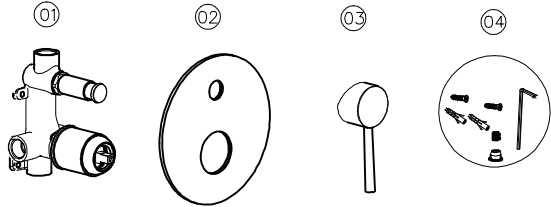

Installation instructions

(I). Important note

- 1. 1 Under the dynamic pressure: $0.1 \pm 0.01\text{Mpa}$ water pressure, the water nozzle (with accessories) for basin, washing and kitchen , the rate of flow is $\leq 0.15\text{L/S}$.
- 1.2 Under the dynamic water pressure of $0.3+0.02\text{Mpa}$, the shower mixer is $\geq 0.33\text{L/S}$. The Basin, shattaf , sink and the spray head is $\geq 0.20\text{L/S}$.
- 2. Temperature recommendation: $4^{\circ}-80^{\circ}$,Working Pressure:150kpa to 500kpa.

(II). Precautions

- 1.The main body and cartridge of the mixer has already been inspected and tested, please do not disassemble or assemble by yourself.
- 2. Necessity in cleaning the dirt in the embedded water pipe before installation.
- 3.Necessity inspection for tight connection in every parts and water leakage after installation.
- 4. The left side of the pipe is for hot water, the right one is for hot water , make sure they are not on the opposite way .

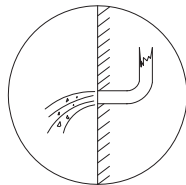

Sluice the pipe

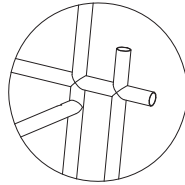

check the pipe

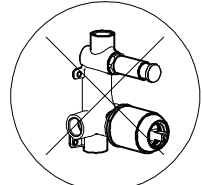

main body of the showe

Installation procedures

- 1.Please make a slot inside the wall and bury the tube. Connect the inlet pipes for hot and cold water. Hot water inlet is on the left in red , and the cold water is on the right in blue .
- 2.1 Conceal the pipe in wall as follows. Please try the water before conceal the wall, in case the body and connecting pipes to be cracked.
- 2.2 Please fix the water outlet. Choose an appropriate height to fix the holder for hand held shower head .
- 2.Install the outer part including the diverter, handle, and shower head according to the photo .

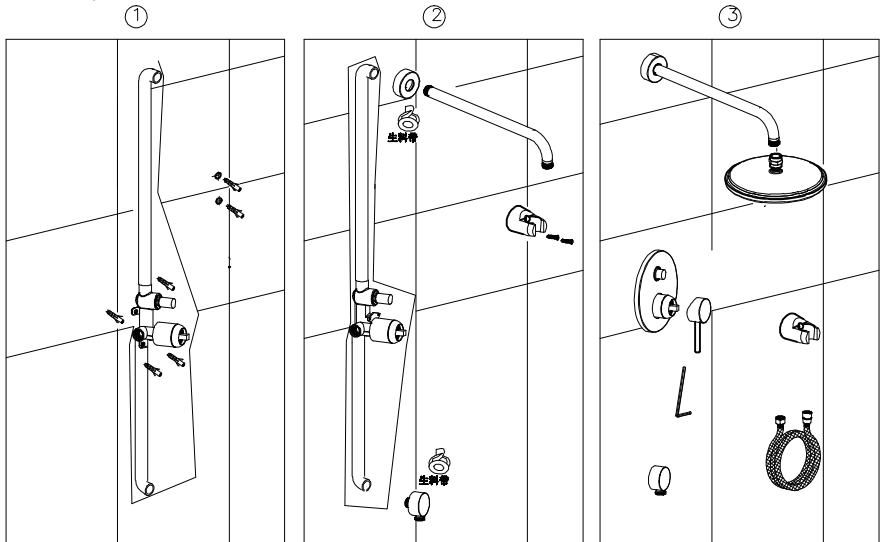

Test:

- 1. Turn off the mixer, and turn on the water valve to see if there is any leaking in connectors.
- 2. Turn on the mixer, and turn on the water valve and check water leaking by changing the diverter .
- 3. During using , please don't tweak the hand shower hose wildly in case get cracking.

Maintenance:

(I) Clean the surface frequently or in a regular basis to keep it bright.

- 1.To mop the mixer's surface frequently by using clean water, colorless glass cleaner and soft fabric , not the abrasive liquid or material .
- 2.DO NOT use acid cleaner to clean the mixer , the electroplating surface is corrosive.
- 3.DO NOT use any coarse cleaner powder or brush to clean the mixer.

(II) Regular cleaning

- 1.Under regular water pressure, when the flow is reducing , please brush the parts after vinegar soaking .

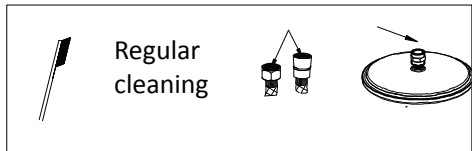
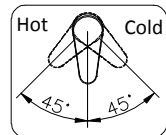
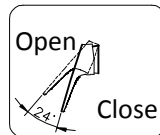

The instruction of single lever wall mounted cold and hot basin mixer

Product introduction

(I). Notification :

- 1.Please check the mixer and all the accessories once you opened the package .
- 2.The printed picture is for reference only , the product is according to the real goods .
- 3.We reserve the right to change the accessories without prior notice if the replacement is not influencing the use .
- 4.Thank you for selecting us and buying our products.

(II).Please check accessories : (refer to the picture on the right)

05	Handle	1	Alloy	
04	Spout	2	Brass	
03	Mixer decorative plate	1	Brass	
02	Spout decorative plate	1	Brass	
01	Main body of the mixer	1	Brass	With gasket
No.	Name	Quantity	Material	Note

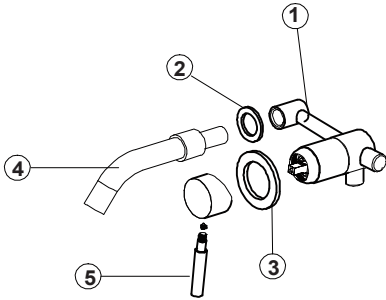

Installation instructions

(I). Important note

- 1. 1 Under the dynamic pressure: $0.1 \pm 0.01 \text{Mpa}$ water pressure, the water nozzle (with accessories) for basin, washing and kitchen , the rate of flow is $\leq 0.15 \text{L/S}$.
- 1.2 Under the dynamic water pressure of $0.3 + 0.02 \text{Mpa}$, the shower mixer is $\geq 0.33 \text{L/S}$.The Basin, shattaf , sink and the spray head is $\geq 0.20 \text{L/S}$.
- 2. Temperature recommendation: $4^{\circ} - 80^{\circ}$,Working Pressure:150kpa to 500kpa.

(II). Precautions:

- 1. Necessity in cleaning the dirt in the embedded water pipe before installation.
- 2. Necessity inspection for tight connection in every parts and water leakage after installation.
- 3. To avoid cracking , please make sure the water inlet flexible pipes are not twisted when in use.

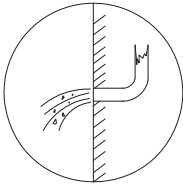

Sluice the pipe

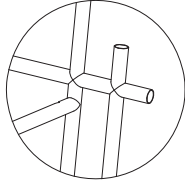

check the pipe

(III). Installation procedures

- 1. Slotting the wall according to the picture , connect the buried hot and cold water pipes to the mixer body . The red dot on the left side is for hot water , blue dot on the right side is for cold water.
- 2. Sealing up the wall like the picture . Please try the water operation before sealing the wall to prevent the pipes or mixer body to be cracking.
- 3. Fix the handle to the mixer.
- 4. Finished product after installation .

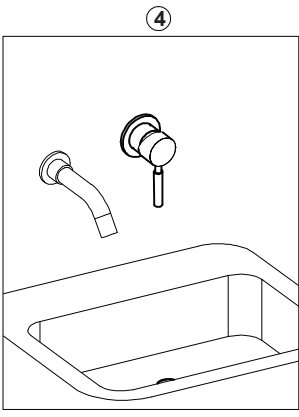
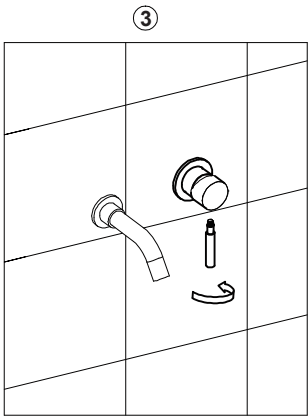
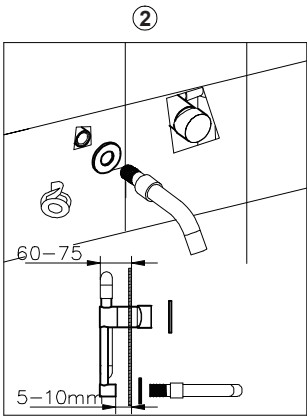
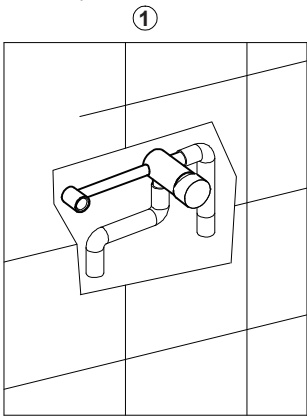

Maintenance:

Clean the surface frequently or in a regular basis to keep it bright.

- 1.To mop the mixer's surface frequently by using clean water, colorless glass cleaner and soft fabric , not the abrasive liquid or material .
- 2.DO NOT use acid cleaner to clean the mixer , the electroplating surface is corrosive.
- 3.DO NOT use any coarse cleaner powder or brush to clean the mixer.
- 4.Under regular water pressure, when the flow is reducing , please brush the parts after vinegar soaking .

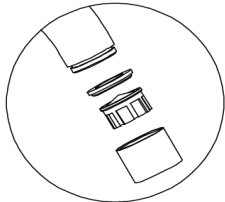
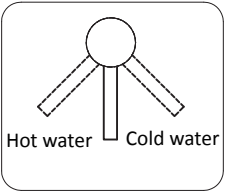
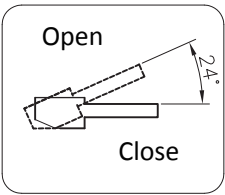

Working illusion of the spout

The instruction of double lever hot and cold in wall mixer

Important note

1. 1 Under the dynamic pressure: $0.1 \pm 0.01\text{Mpa}$ water pressure, the water nozzle (with accessories) for basin, washing and kitchen , the rate of flow is $\leq 0.15\text{L/S}$.
- 1.2 Under the dynamic water pressure of $0.3+0.02\text{Mpa}$, the shower mixer is $\geq 0.33\text{L/S}$. The Basin, shattaf , sink and the spray head is $\geq 0.20\text{L/S}$.
2. Temperature recommendation: $4^{\circ}-80^{\circ}$, Working Pressure: 150kpa to 500kpa.

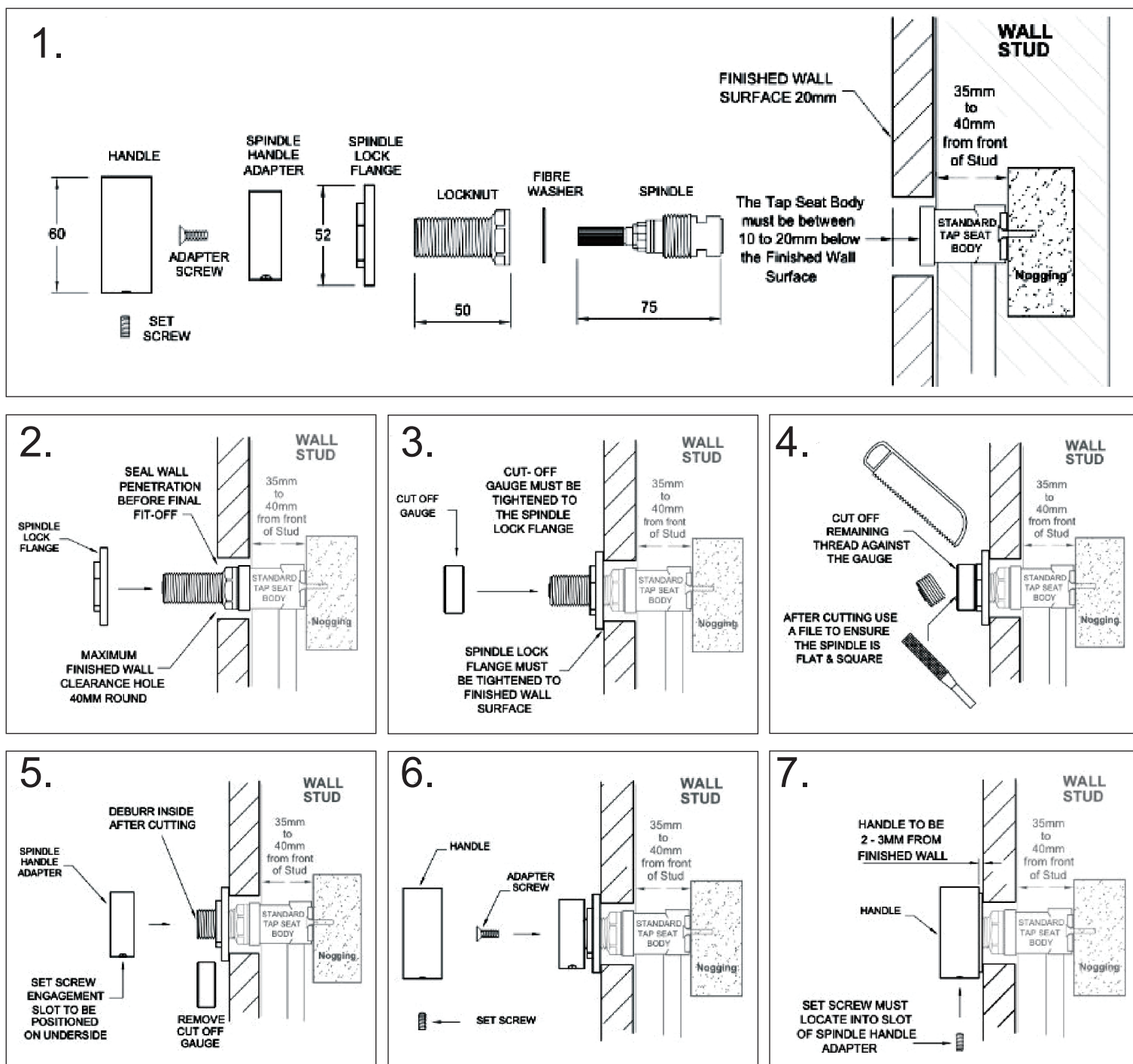

Maintenance:

Clean the surface frequently or in a regular basis to keep it bright.

- 1.To mop the mixer's surface frequently by using clean water, colorless glass cleaner and soft fabric , not the abrasive liquid or material .
- 2.DO NOT use acid cleaner to clean the mixer , the electroplating surface is corrosive.
- 3.DO NOT use any coarse cleaner powder or brush to clean the mixer.
- 4.Under regular water pressure, when the flow is reducing , please brush the parts after vinegar soaking .

The instruction of floor standing bathtub mixer

Product introduction

(I). Notification :

- 1.Please check the mixer and all the accessories once you opened the package .
- 2.The printed picture is for reference only , the product is according to the real goods .
- 3.We reserve the right to change the accessories without prior notice if the replacement is not influencing the use .
- 4.Thank you for selecting us and buying our products.

(II).Please check accessories :

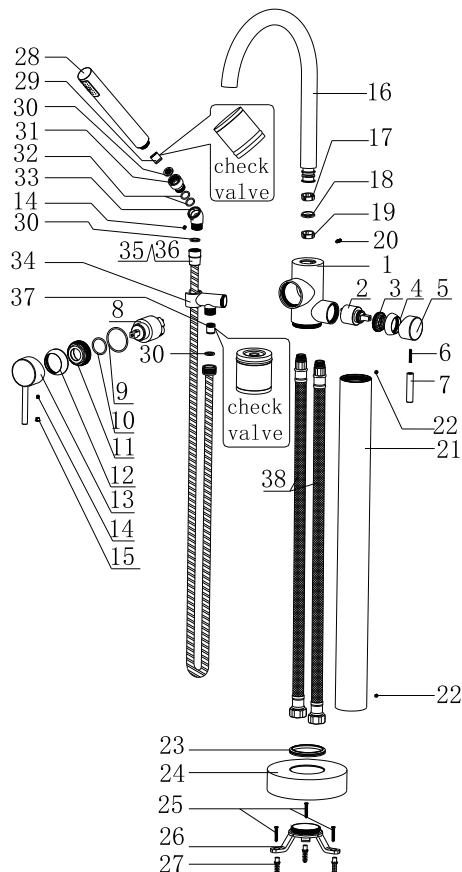

38	Supply Hose	2
37	Check Valve	1
36	O-Ring	1
35	Spray Hose	1
34	Shower Head Holder Assembly	1
33	Adapter	1
32	O-Ring	2
31	Adapter	1
30	Washer	3
29	Check Valve	1
28	Shower Head	1
27	Adapter	3
26	Strut	1
25	Screw	3
24	Cover	1
23	Ring	1
22	Screw	2
21	Coop	1
20	Screw	1
19	Card Wreath	1
18	Y-Ring	1
17	Card Wreath	1
16	Spout Assembly	1
15	Button(red/blue)	1
14	Screw	2
13	Handle	1
12	Cup	1
11	Bonnet	1
10	O-Ring	1
9	O-Ring	1
8	Cartridge	1
7	Handle	1
6	Screw	1
5	Handle Cup	1
4	Cup	1
3	Bonnet	1
2	Cartridge	1
1	Body	1
NO.	PART NAME	QTY

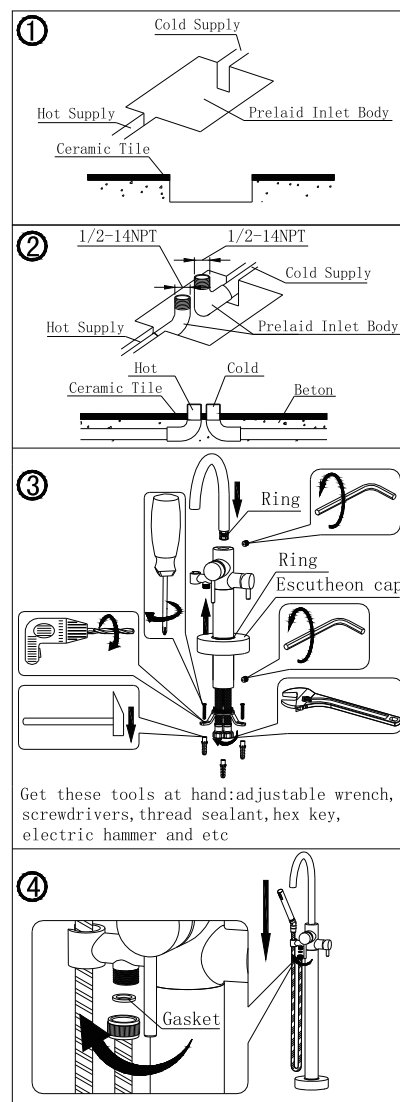

Installation instructions

(I). Important note

1. Under the dynamic pressure: $0.1 \pm 0.01 \text{Mpa}$ water pressure, the water nozzle (with accessories) for basin, washing and kitchen , the rate of flow is $\leq 0.15 \text{L/S}$.
- 1.2 Under the dynamic water pressure of $0.3 \pm 0.02 \text{Mpa}$, the shower mixer is $\geq 0.33 \text{L/S}$.The Basin, shattaf , sink and the spray head is $\geq 0.20 \text{L/S}$.
2. Temperature recommendation: $4^{\circ} - 80^{\circ}$,Working Pressure: 150kpa to 500kpa .

(II). Precautions:

1. Necessity in cleaning the dirt in the embedded water pipe before installation.
2. Necessity inspection for tight connection in every parts and water leakage after installation.
3. To avoid cracking , please make sure the water inlet flexible pipes are not twisted when in use.

Maintenance:

Clean the surface frequently or in a regular basis to keep it bright.

- 1.To mop the mixer's surface frequently by using clean water, colorless glass cleaner and soft fabric , not the abrasive liquid or material .
- 2.DO NOT use acid cleaner to clean the mixer , the electroplating surface is corrosive.
- 3.DO NOT use any coarse cleaner powder or brush to clean the mixer.
- 4.Under regular water pressure, when the flow is reducing , please brush the parts after vinegar soaking .

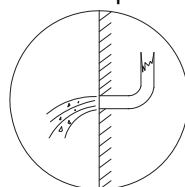

Sluice the pipe

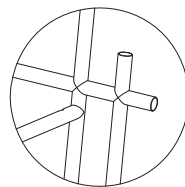

check the pipe

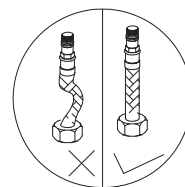

Hose installation

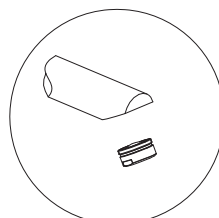

Working illusion of the spout

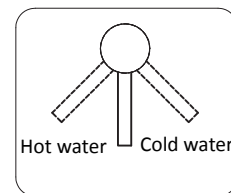
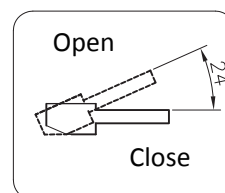

The instruction of pull out mixer

Product introduction

(I). Notification :

- 1.Please check the mixer and all the accessories once you opened the package .
- 2.The printed picture is for reference only , the product is according to the real goods .
- 3.We reserve the right to change the accessories without prior notice if the replacement is not influencing the use .
- 4.Thank you for selecting us and buying our products.

(II).Please check accessories :

NO.	DESCRIPTION	Qty
1	PULL-OUT SPRAY	1PC
2	PULL-OUT HOSE	1PC
3	HANDLE	1PC
4	BODY	1PC
5	BASE FLANGE	1PC
6	INLET CONNECTION FOR PART (2)	1PC
7	WASHER	1PC
8	THREADED ROD	1PC
9	WASHER	1PC
10	HEXAGONAL LOCK NUT	1PC
11	FLEXIBLE HOSES	2PC
12	WEIGHT FOR PULL-OUT HOSE	1PC

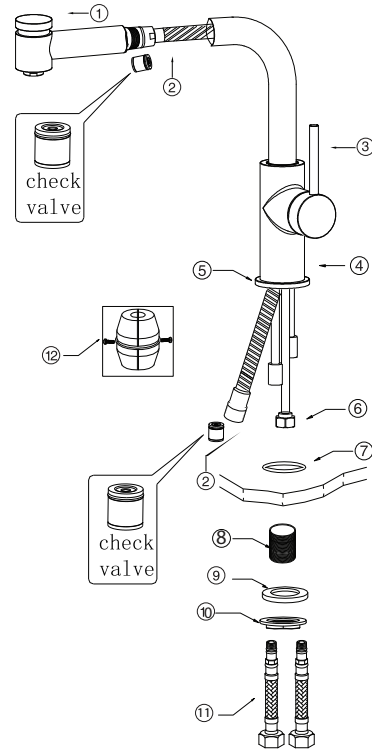

Installation instructions

(I). Important note

1. Under the dynamic pressure: $0.1 \pm 0.01 \text{Mpa}$ water pressure, the water nozzle (with accessories) for basin, washing and kitchen , the rate of flow is $\leq 0.15 \text{L/S}$.
- 1.2 Under the dynamic water pressure of $0.3 \pm 0.02 \text{Mpa}$, the shower mixer is $\geq 0.33 \text{L/S}$.The Basin, shattaf , sink and the spray head is $\geq 0.20 \text{L/S}$.
2. Temperature recommendation: $4^{\circ} - 80^{\circ}$,Working Pressure:150kpa to 500kpa.

(II). Precautions:

1. Necessity in cleaning the dirt in the embedded water pipe before installation.
2. Necessity inspection for tight connection in every parts and water leakage after installation.
3. To avoid cracking , please make sure the water inlet flexible pipes are not twisted when in use.

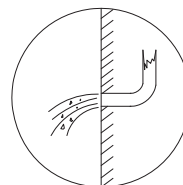

Sluice the pipe

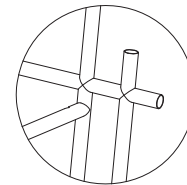

check the pipe

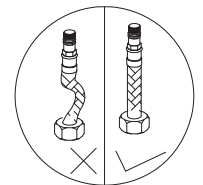

Hose installation

(III).Installation procedures

1. Screw flexible hoses under the body.
2. Insert O-ring washer under base flange.
3. Insert threaded rod under body.
4. Insert washer through threaded rod.
5. Screw hexagonal lock nut on to threaded rod and tighten.
6. Connect pull-out hose to inlet connection.
7. Attach weight to pull out hose.

Maintenance:

Clean the surface frequently or in a regular basis to keep it bright.

- 1.To mop the mixer's surface frequently by using clean water, colorless glass cleaner and soft fabric , not the abrasive liquid or material .
- 2.DO NOT use acid cleaner to clean the mixer , the electroplating surface is corrosive.
- 3.DO NOT use any coarse cleaner powder or brush to clean the mixer.
- 4.Under regular water pressure, when the flow is reducing , please brush the parts after vinegar soaking .

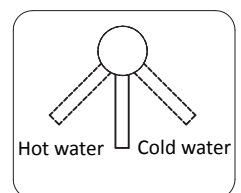
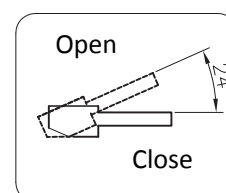
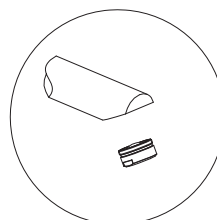

Working illusion of the spout

The instruction of Dual-Handle concealed thermostatic shower valve

Product introduction

(I). Notification :

- 1.Please check the mixer and all the accessories once you opened the package .
- 2.The printed picture is for reference only , the product is according to the real goods .
- 3.We reserve the right to change the accessories without prior notice if the replacement is not influencing the use .
- 4.Thank you for selecting us and buying our products.

(II).Please check accessories :

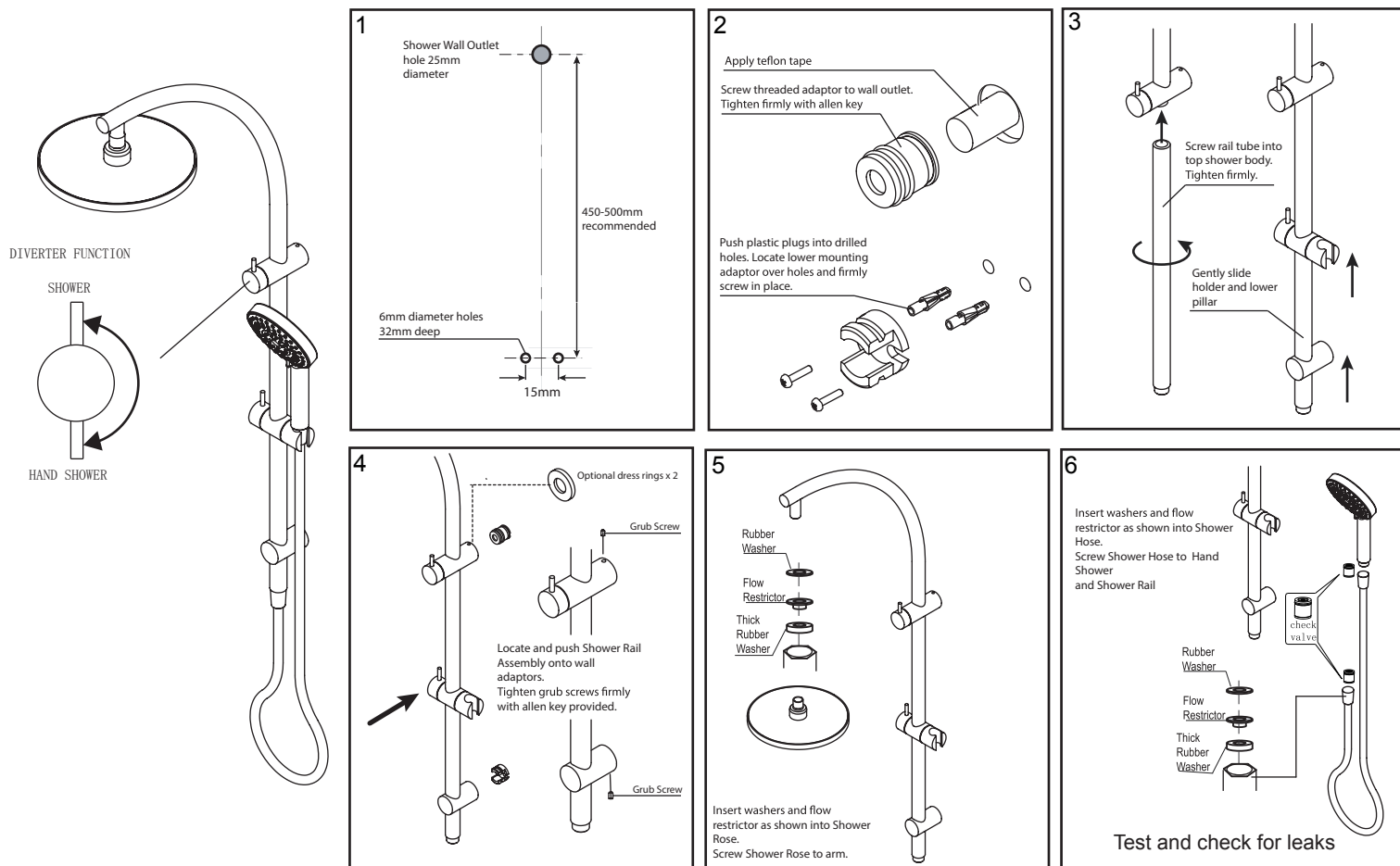

Installation instructions

(III).Installation procedures

(I). Important note

1. Under the dynamic pressure: $0.1 \pm 0.01\text{Mpa}$ water pressure, the water nozzle (with accessories) for basin, washing and kitchen , the rate of flow is $\leq 0.15\text{L/S}$.
- 1.2 Under the dynamic water pressure of $0.3+0.02\text{Mpa}$, the shower mixer is $\geq 0.33\text{L/S}$.The Basin, shattaf , sink and the spray head is $\geq 0.20\text{L/S}$.
2. Temperature recommendation: $4^{\circ}-80^{\circ}$,Working Pressure:150kpa to 500kpa.

(II). Precautions:

1. Necessity in cleaning the dirt in the embedded water pipe before installation.
2. Necessity inspection for tight connection in every parts and water leakage after installation.
3. To avoid cracking , please make sure the water inlet flexible pipes are not twisted when in use.

Clean the surface frequently or in a regular basis to keep it bright.

- 1.To mop the mixer's surface frequently by using clean water, colorless glass cleaner and soft fabric , not the abrasive liquid or material .
- 2.DO NOT use acid cleaner to clean the mixer , the electroplating surface is corrosive.
- 3.DO NOT use any coarse cleaner powder or brush to clean the mixer.
- 4.Under regular water pressure, when the flow is reducing , please brush the parts after vinegar soaking .

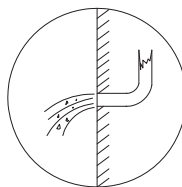

Sluice the pipe

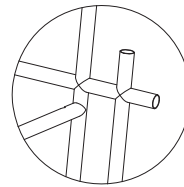

check the pipe

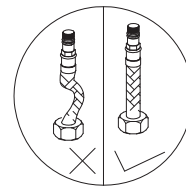

Hose installation

The instruction of Dual-Handle concealed thermostatic shower valve

Product introduction

(I). Notification :

- 1.Please check the mixer and all the accessories once you opened the package .
- 2.The printed picture is for reference only , the product is according to the real goods .
- 3.We reserve the right to change the accessories without prior notice if the replacement is not influencing the use .
- 4.Thank you for selecting us and buying our products.

(II)Please check accessories : (refer to the picture on the right)

No.	Name	Quantity
1	Faucet main body	1
2	Plate	1
3	Positioning ring	1
4	Thermostatic handle	1
5	Screw	2
6	Lever	2
7	Open and close control	1
8	Self tapping screw	2
9	Swell plastic button	2
10	Allen Key	1

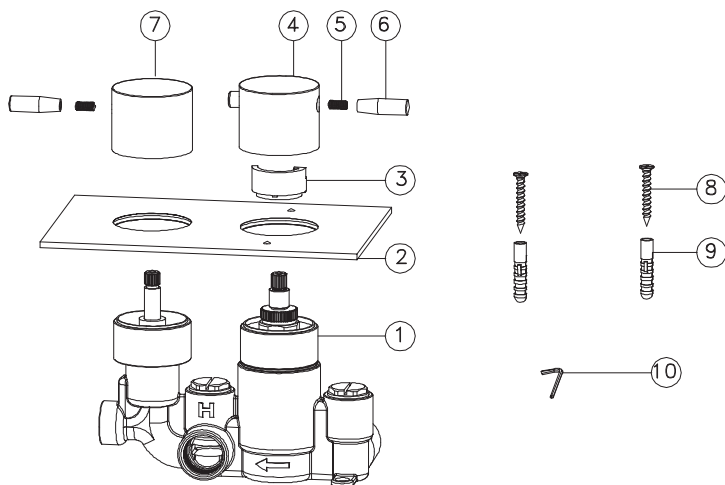

Installation instructions

(I). Important note

1. Please check all the fittings in accordance with the Fittings List. If there is any shortage or damage, please contact the seller without delay.
2. The main body of the faucet has been inspected and tested by the factory. Disassemble only by the professionals.
3. The thermostatic faucet will be faulty if the hot (left side) and cold (right side) water inlet is upside down.
4. Please clean the water supply tube before connecting the thermostatic faucet.
5. Applicable water pressure is 0.05-0.5Mpa. If beyond, the pressure reducing valve is needed.
- 6.Applicable temperature is 45 - 100 ℃ for hot water; 4-30 ℃ for cold water.
7. Please prevent the faucet from cold environment if it is not being used.

(II).Installation procedures

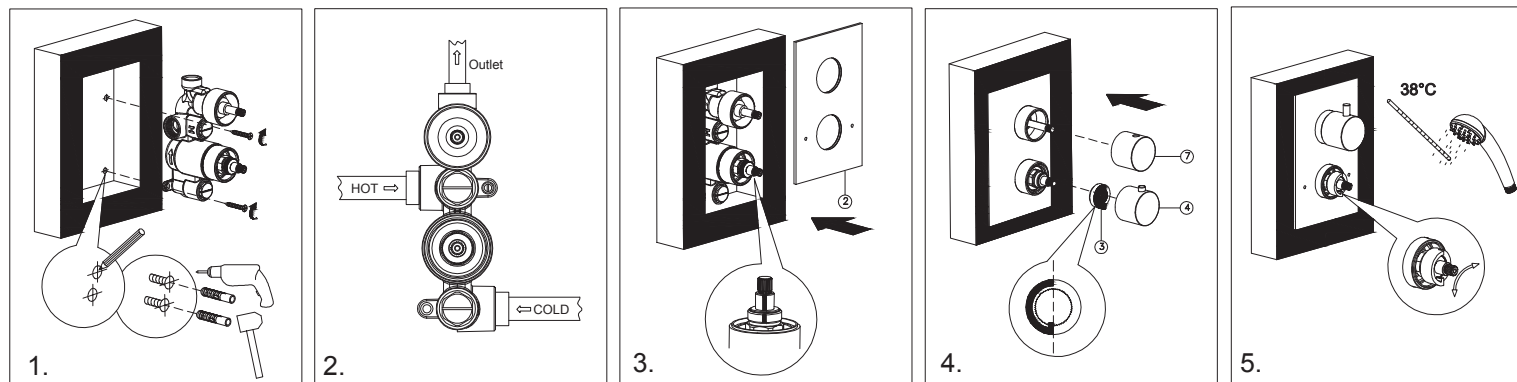

- 1.a. Dig a suitable size hole on the wall in accordance with the dimension drawing. b. Put the faucet main body (1) inside the wall and mark the screw fixing positions.c. Dig a $\Phi 7$ hole with electric drill, and insert the swell plastic button (9).d. Fix the faucet main body with self tapping screw .
- 2.Link the hot water to left side (H) and cold water on right side (C) with tube and adapter. Install all the accessories in the outlet, including shower head and hand shower, and check if there is any leaking. Do not install the hot and cold water upside down, or the faucet won't be able to adjust the temperature.
- 3.After finishing installing the faucet main body, please check if the indicative line of the thermostatic cartridge is parallel, and cover the plate.
- 4.Fix the positioning ring (3), thermostatic handle (4), and open and close control (7).
- 5.Please disassemble the thermostatic handle , and twist the cartridge left and right to $38^{\circ}\text{C} \pm 1^{\circ}\text{C}$ if there has deviation of the water temperature, and fix the thermostatic control assembly. Please note that the deviation between $\pm 2^{\circ}\text{C}$ is normal.

Maintenance and Care

- 1.Do not use any abrasive cleanser or tools, such as emery cloth or mental wire when cleaning .
- 2.Do not use any acid cleanser or soap.
- 3.Please use litmusless cleanser. Rinse the surface first and dry it with soft cotton cloth.
- 4.When the water current is low and the temperature is uneasy to adjust, please clean the silt in the filter. As it's shown below, please disassemble the control, handle and plate, unscrew the cover by slotted screwdriver in anti-clock direction. Clean the filter with soft brush. Finally fix it.

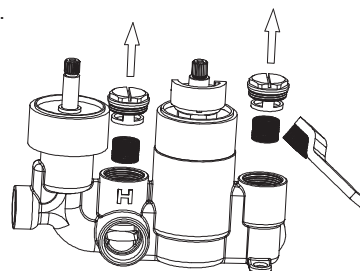

If the thermostatic water temperature has a big difference from when it was set,please remove the hand shower and open the water switch to its largest extent. Adjust the temperature control assembly from its highest temperature to the lowest one. Please try several times till the silt is flushed out of the cartridge. If the problem still exists, please inquire or repair under the instructions of the professionals.

The instruction of Three-handle concealed thermostatic shower valve

Product introduction

(I). Notification :

- 1.Please check the mixer and all the accessories once you opened the package .
- 2.The printed picture is for reference only , the product is according to the real goods .
- 3.We reserve the right to change the accessories without prior notice if the replacement is not influencing the use .
- 4.Thank you for selecting us and buying our products.

(II)Please check accessories : (refer to the picture on the right)

No.	Name	Quantity
1	Faucet main body	1
2	Plate	1
3	Positioning ring	1
4	Thermostatic handle	1
5	Screw	2
6	Lever	2
7	Open and close control	1
8	Self tapping screw	2
9	Swell plastic button	2
10	Allen Key	1

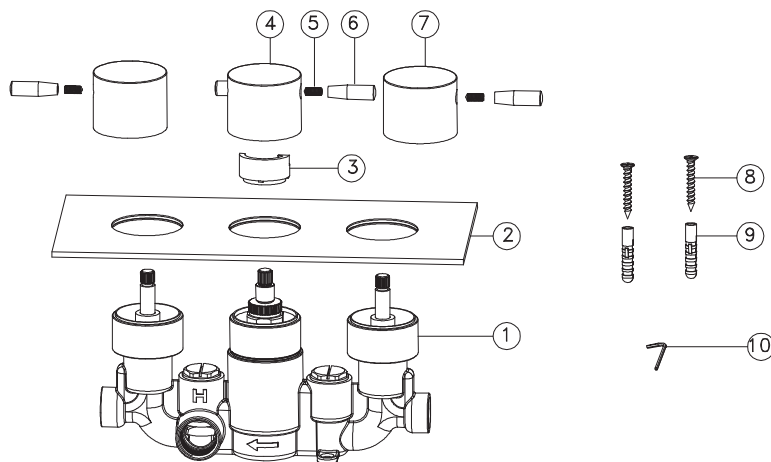

Installation instructions

(I). Important note

1. Please check all the fittings in accordance with the Fittings List. If there is any shortage or damage, please contact the seller without delay.
2. The main body of the faucet has been inspected and tested by the factory. Disassemble only by the professionals.
3. The thermostatic faucet will be faulty if the hot (left side) and cold (right side) water inlet is upside down.
4. Please clean the water supply tube before connecting the thermostatic faucet.
5. Applicable water pressure is 0.05-0.5Mpa. If beyond, the pressure reducing valve is needed.
- 6.Applicable temperature is 45 - 100 ℃ for hot water; 4-30 ℃ for cold water.
7. Please prevent the faucet from cold environment if it is not being used.

(II).Installation procedures

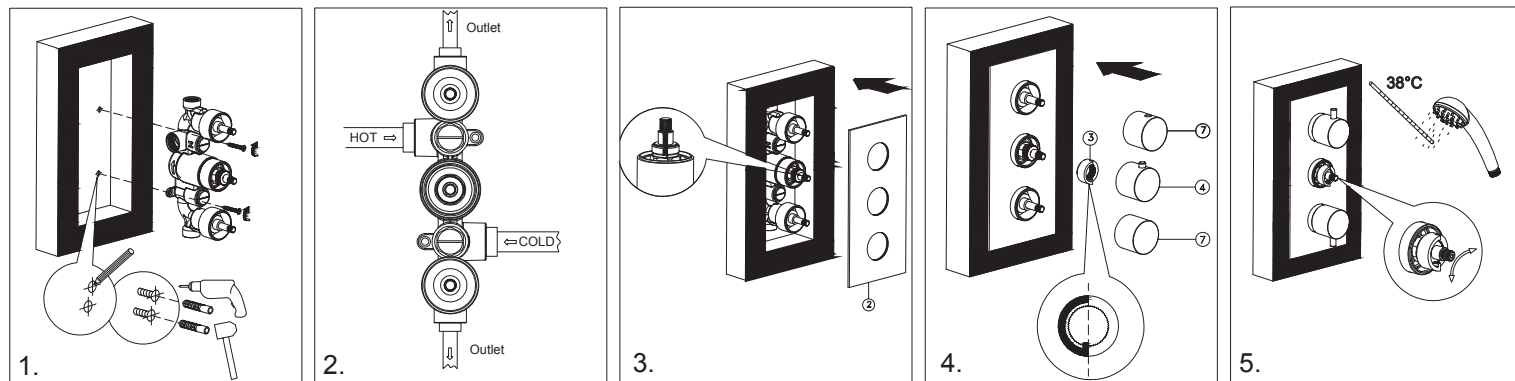

- 1.a. Dig a suitable size hole on the wall in accordance with the dimension drawing. b. Put the faucet main body (1) inside the wall and mark the screw fixing positions.c. Dig a $\Phi 7$ hole with electric drill, and insert the swell plastic button (9).d. Fix the faucet main body with self tapping screw .
- 2.Link the hot water to left side (H) and cold water on right side (C) with tube and adapter. Install all the accessories in the outlet, including shower head and hand shower, and check if there is any leaking. Do not install the hot and cold water upside down, or the faucet won't be able to adjust the temperature.
- 3.After finishing installing the faucet main body, please check if the indicative line of the thermostatic cartridge is parallel, and cover the plate.
- 4.Fix the positioning ring (3), thermostatic handle (4), and open and close control (7).
- 5.Please disassemble the thermostatic handle , and twist the cartridge left and right to $38^{\circ}\text{C} \pm 1^{\circ}\text{C}$ if there has deviation of the water temperature, and fix the thermostatic control assembly. Please note that the deviation between $\pm 2^{\circ}\text{C}$ is normal.

Maintenance and Care

- 1.Do not use any abrasive cleanser or tools, such as emery cloth or mental wire when cleaning .
- 2.Do not use any acid cleanser or soap.
- 3.Please use litmusless cleanser. Rinse the surface first and dry it with soft cotton cloth.
- 4.When the water current is low and the temperature is uneasy to adjust, please clean the silt in the filter. As it's shown below, please disassemble the control, handle and plate, unscrew the cover by slotted screwdriver in anti-clock direction. Clean the filter with soft brush. Finally fix it.

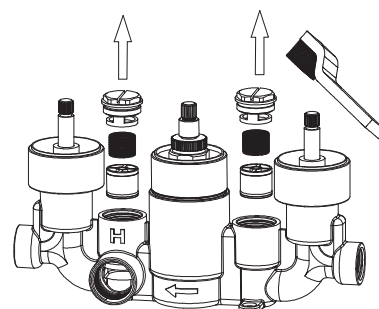

If the thermostatic water temperature has a big difference from when it was set, please remove the hand shower and open the water switch to its largest extent. Adjust the temperature control assembly from its highest temperature to the lowest one. Please try several times till the silt is flushed out of the cartridge. If the problem still exists, please inquire or repair under the instructions of the professionals.

Performance Warranty Period and Service Conditions

1.Express Warranties

Our goods come with guarantees that cannot be excluded under the Australian Consumer Law. You are entitled to a replacement or refund for a major failure and compensation for any other reasonably foreseeable loss or damage.

You are also entitled to have the goods repaired or replaced if the goods fail to be of acceptable quality and the failure does not amount to a major failure.

Note: These warranty periods apply only to products that were purchased after 1 Janu 2016.

2.Content of warranty

7 years replacement product warranty from date of purchase. We will repair or, at its option, replace any goods which are defective through faulty workmanship or materials, free of charge, within the first 1 years of the warranty.

An additional warranty of 6 years for replacement parts (labour is excluded) applies for defective product through faulty workmanship or materials. Shower hoses have a 2 years warranty.

☒ 15 years warranty of product's main body.

☒ 7 years replacement product or parts (ceramic cartridge, water saving aerator, flexible hoses etc) .

☒ 3 years replacement warranty for special surface finished products.

2.2.Bathroom Accessories

7 year replacement product warranty from date of purchase.

We will repair or, at its option, replace any goods which are defective through faulty workmanship or materials, free of charge, within the first 1 year of the warranty.

An additional warranty of 6 years for replacement parts (labour is excluded) applies for defective product through faulty workmanship or materials.

2.3.Ceramic Product

7 year replacement product warranty from date of purchase.

We will repair or, at its option, replace any goods which are defective through faulty workmanship or materials, free of charge.

2.4.Pop-up waste & Floor drainer

Pop-up waste: 7 years replacement product warranty from date of purchase.

We will repair or, at its option, replace any goods which are defective through faulty workmanship or materials.

Floor drainer: 15 years replacement product warranty from date of purchase.

We will repair or, at its option, replace any goods which are defective through faulty workmanship or materials.

☒ 3 years replacement warranty for special surface finished products

2.5. Warranty Periods: Residential

Subject to the exclusions in section 3, We warrants that our products which are provided for any consumers who use the products manufactured by We in any residential home will be free from defects of materials or workmanship for the 7 years periods specified (periods commencing on the date of purchase or, for new buildings, the date of handover).

2.5.1 Excludes damage to ceramic disc cartridges from pieces of copper tube, plastic tube, sand, dirt, or thread tape etc.

2.5.5 Includes all Chrome products. All other finishes are subject to a 5 / 7 / 15 years replacement products or parts, and 1 year replacement product or part.

2.6.Warranty Periods: Commercial

Subject to the exclusions in section 3, We warrants that our products which are provided for any consumers who use the products manufactured by We other than in a residential home (for example hotels, aged care facilities, hospitals, schools, factories, motels) ,since all of above place face many uncertainties, will be free from defects of materials or workmanship for 3 years periods specified (periods commencing on the date of purchase or, for new buildings, the date of handover).

2.7.Other exclusions to the warranty include:

☒ Jumper Valves

☒ O-rings and washers

☒ Aerator Inserts

☒ Normal wear & tear 1. Tapware/Shower

Performance Warranty Period and Service Conditions

3.Warranty Exclusions

Subject always to any overriding obligation pursuant to the Australian Consumer Law, the above warranties shall not apply where:

the consumer is not able to provide proof of purchase or equivalent documentation which confirms that the relevant product was purchased from We.the relevant products are not installed by a licensed plumber and in accordance with the manufacturer's installation instructions and, in particular:non-approved water flow regulating devices must not be fitted. outlet aerator inserts must be regularly cleaned and replaced.

the relevant product requires repairs due to damage resulting from accident, misuse (including use for incorrect applications), incorrect installation, cleaning or maintenance, unauthorised modification, tampering or unauthorised repairs by any persons, use of defective or incompatible accessories or exposure to abnormally corrosive conditions, adhesives or sealants.

the product is not the product to which this Warranty Card was attached or supplied with;

the defective part relates to a consumable part of the We product which require routine replacement;

the products are not to relevant National Standards and State Regulations;

the relevant products are exposed to environmental elements;

the relevant products are exposed to water pressures and or temperatures that exceed the following limitations:

Maximum Temperature; 80 degrees;

Minimum Temperature; 4 degree;

Maximum Pressure; 500kPa;

Minimum Pressure; 150kPa (300kPa for Shower/Bath Diverters);

damage occurs as a result of obstructions due to inadequate flushing of system before use;

services or repairs with non-standard replacement parts have been previously undertaken without We written approval;

damage to finishes which arise from installation or post installation use;

4.How to make a claim

lodge the claim with us as soon as possible and no later than 10 Business Days after they first become aware of the breakdown.provide reasonable proof of purchase.

if the product was installed in a new home, provide handover or equivalent documentation.

and provide details relating to the proposed warranty claim.

5.Additional

We reserves the right to alter, or amend this warranty offer in writing at any time. We reserves the right to provide minor components (e.g. handles, aerators, buttons, dress rings, hinges, clips, rod and washers) as 'Parts Only' to the customer.

6.Contact information

Name: Guangzhou Kind Architecture Material CO,LTD

Address: Unit 8, NO.1 Dashadi West, Huangpu District, Guangzhou, Guangdong Province, P.R.China

Telephone: +86 20 23371404

Email: info@watersino.cn

In order to meet customer's satisfaction,we modify our products continuously.
All products presenting in the catalogue are only for reference.

Guangzhou Kind Architecture Material Co., Ltd.

Tel:+86-20-23371404

MP:+8613560320628

Mail :sale@watersino.cn

Skype:watersino

Add: Unit 8, NO.1 Dashadi West Road , Huangpu District, Guangzhou,
Guangdong Province, P.R.China

Web:www.watersino.cn

MAINTENANCE

AERATOR

- 1.Remove the aerator by inserting the key (blue) provided in the box. Turn clockwise.
- 2.Place aerator in water for 1 hour.
- 3.Rinse and re-assemble the aerator to spout.

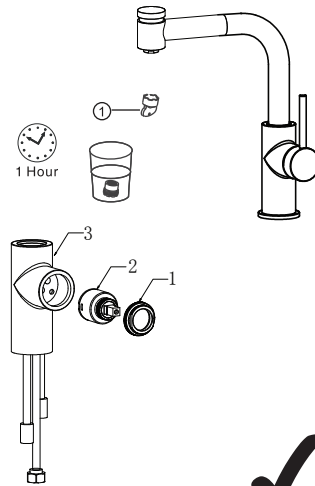

CARTRIDGE

- 1.After removing the handle
- 2.Unscrew lock nut (1)
- 3 .The cartridge (2) is now free
- 4 .Re-assemble in reverse

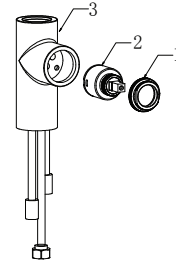

CLEANING

Constant or regular cleaning keeps the tapware lustre

✓ Only use clear water to rinse and soft cotton cloth to dry

Never use any abrasive products (such as cleaners, cloths, or paper), acidic detergent, harsh cleaner or soap.

✓=Soft Cotton Cloth	✗=Acid, Strong Detergent
---------------------	--------------------------

In case of thick sediments proceed as follows:

1. Clean the surface of your tapware with clear water and soft cotton cloth.
2. Use any of the following to remove the dirt:
 - ✓ Mild liquid detergent
 - ✓ Clear liquid glass cleaner, non-acidic, non-abrasive gentle liquid or fully dissolved powder cleaner mixed according to the manufacturers directions.
 - ✓ Non-abrasive liquid polisher
3. After clean, rinse the tapware again with clear water to thoroughly remove cleaner and dry it with soft cotton cloth.

In case the water flow is reduced clean the aerator using instruction above.



WARNING



1. Each tapware body is hydraulically pressure tested at factory. Do not attempt to dismantle the assembly by yourself.



2. Before installing the tapware, flush out water lines to make sure that the pipes are free of any dirt or debris: avoid blockages in the cartridges.



3. After installation of tapware, check all connecting points for leaks. Always turn water OFF before removing or disassembling the tapware.



4. Hydraulic pressure for Parisi tapware is 150-500kPa(including hot and cold hydraulic pressure)



5. Open tapware handle to relieve water pressure and ensure that water is shut-off completely.



6. Do not apply undue force when using any tools.



7. Do not bend or squeeze the hoses. Clamp the tools at the terminal ends only.



8. Working temperature is less than 80°C (70°C recommended).